



Life&Slide

MLS72 Profile

OTTOSTUMM
distinctive steel window systems

METALFORM™



Lift&Slide
MLS72 Profile

Lift & Slide MLS72 Profile

OTTOSTUMM's thermal barrier sliding door systems are suited for larger frame dimensions and weights, which are outside the ordinary. The profiles are available in steel, cor-ten steel and marine grade stainless steel AISI 316L.

Steel | Cor-ten Steel | Stainless Steel

The code “MLS72 TB” stands for an extensive family of thermal barrier lift and slide door solutions in steel, galvanized steel, cor-ten steel and stainless steel marine grade AISI 316L.

All profiles are cold formed with 2mm thick steel – ideal solution for large glazing with weights up to 600 kg. The 72 mm profile depth is a perfect compromise between design and security. The extremely strong framing material accommodates security glass up to 50 mm and can be automated.



Features of MLS72

1. 2 mm tubular profile with extremely high moments of inertia
2. Aesthetic cover cap with insulating material
3. Thermal barrier in polyamide PA 6.6
4. Insulated front strike
5. Mechanically fixed rebate gaskets
6. Profiles available in galvanized steel, cor-ten and stainless steel AISI 316L
7. Water drainage
8. Profiles accommodate high-performance glazing
9. Wide range of square and angular glazing beads
10. Manual opening up to 400 Kg and automated up to 600 Kg, single and multiple sliding, pocket solution
11. Fittings with concealed sliding mechanism

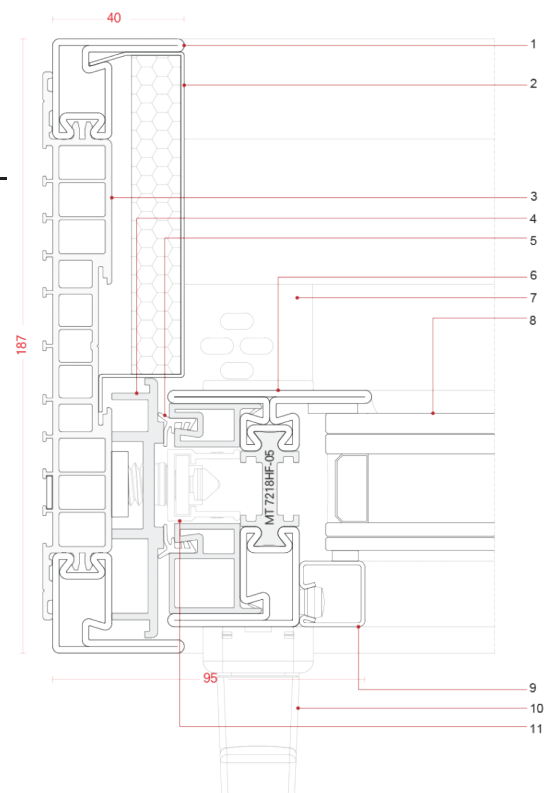

examples

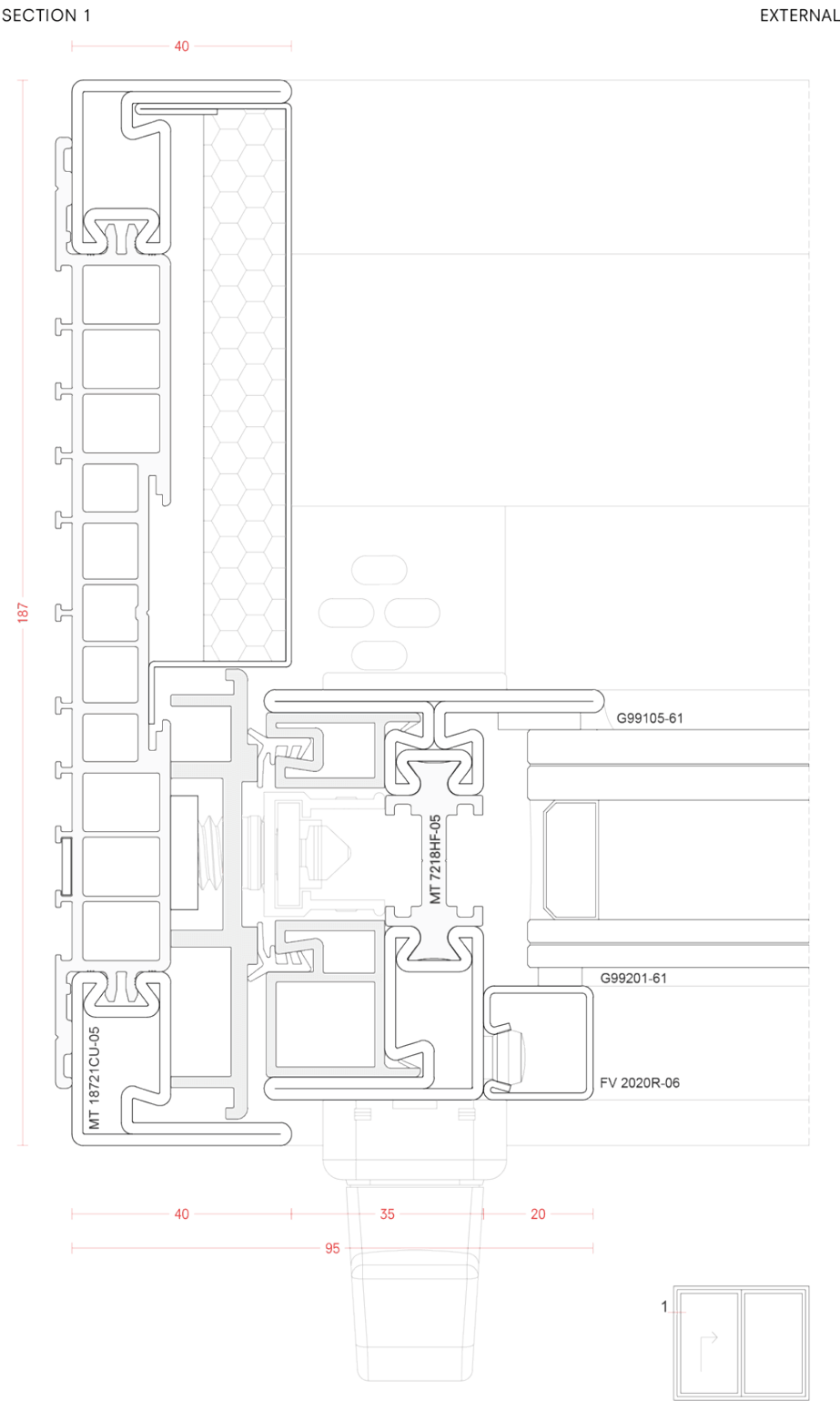

examples

SECTION 2

EXTERNAL

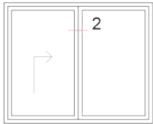
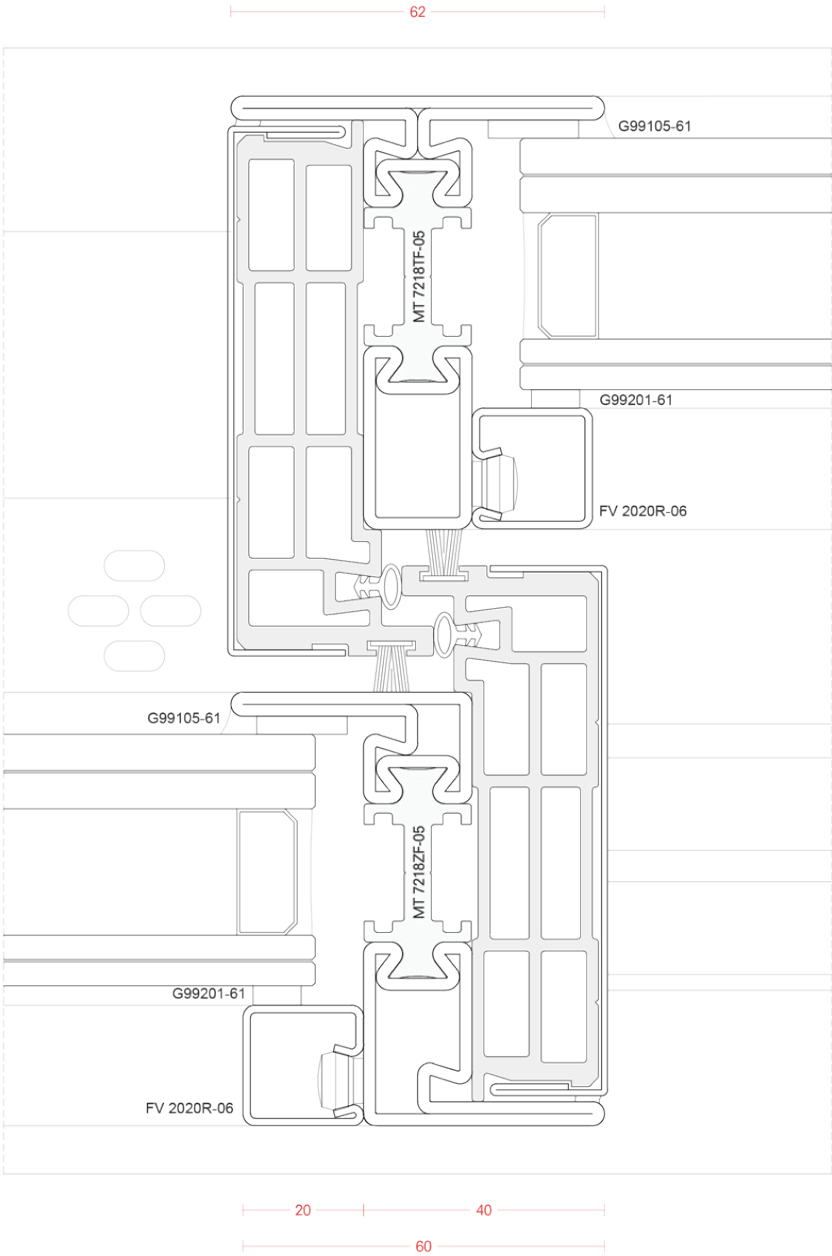

examples

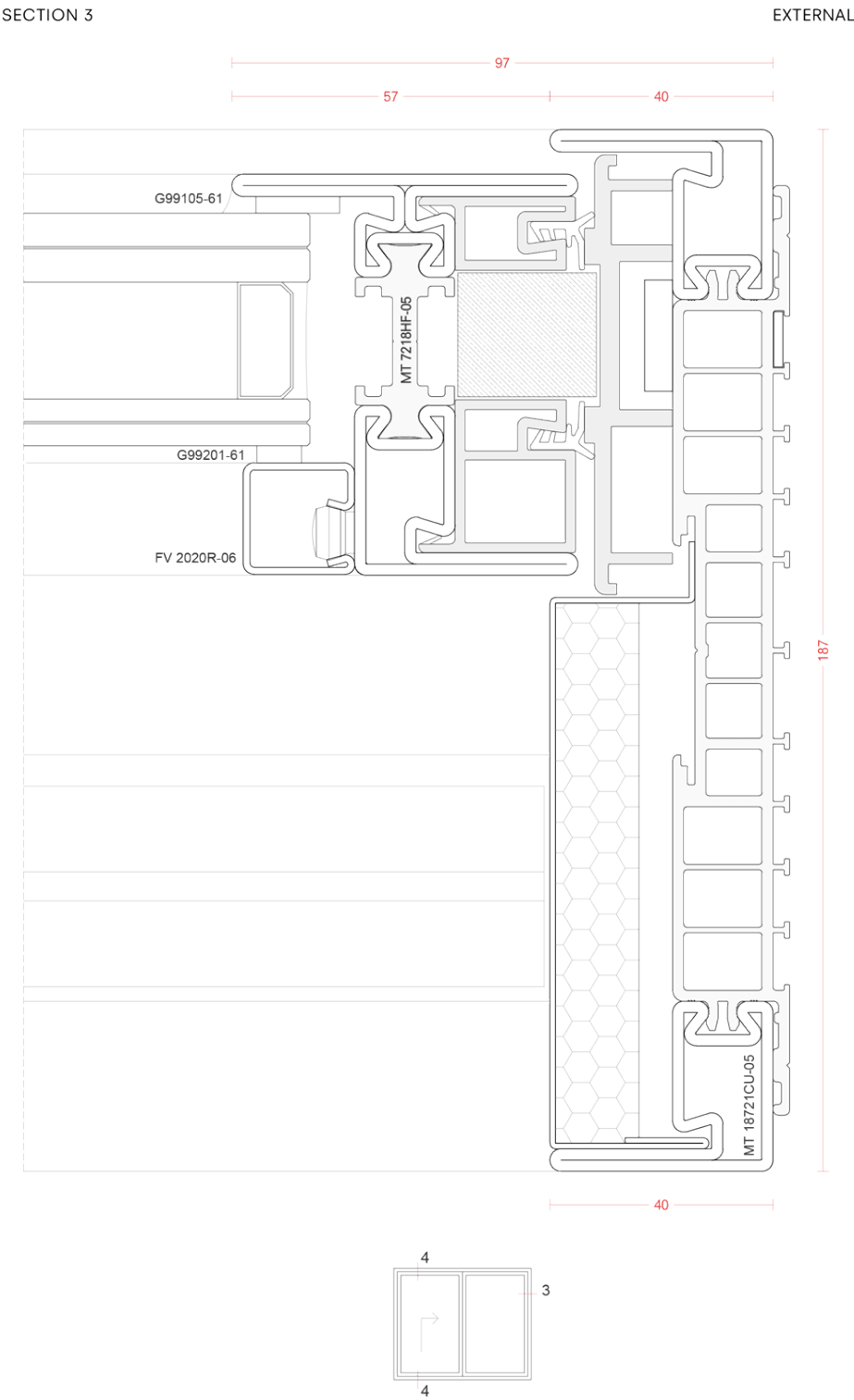

examples

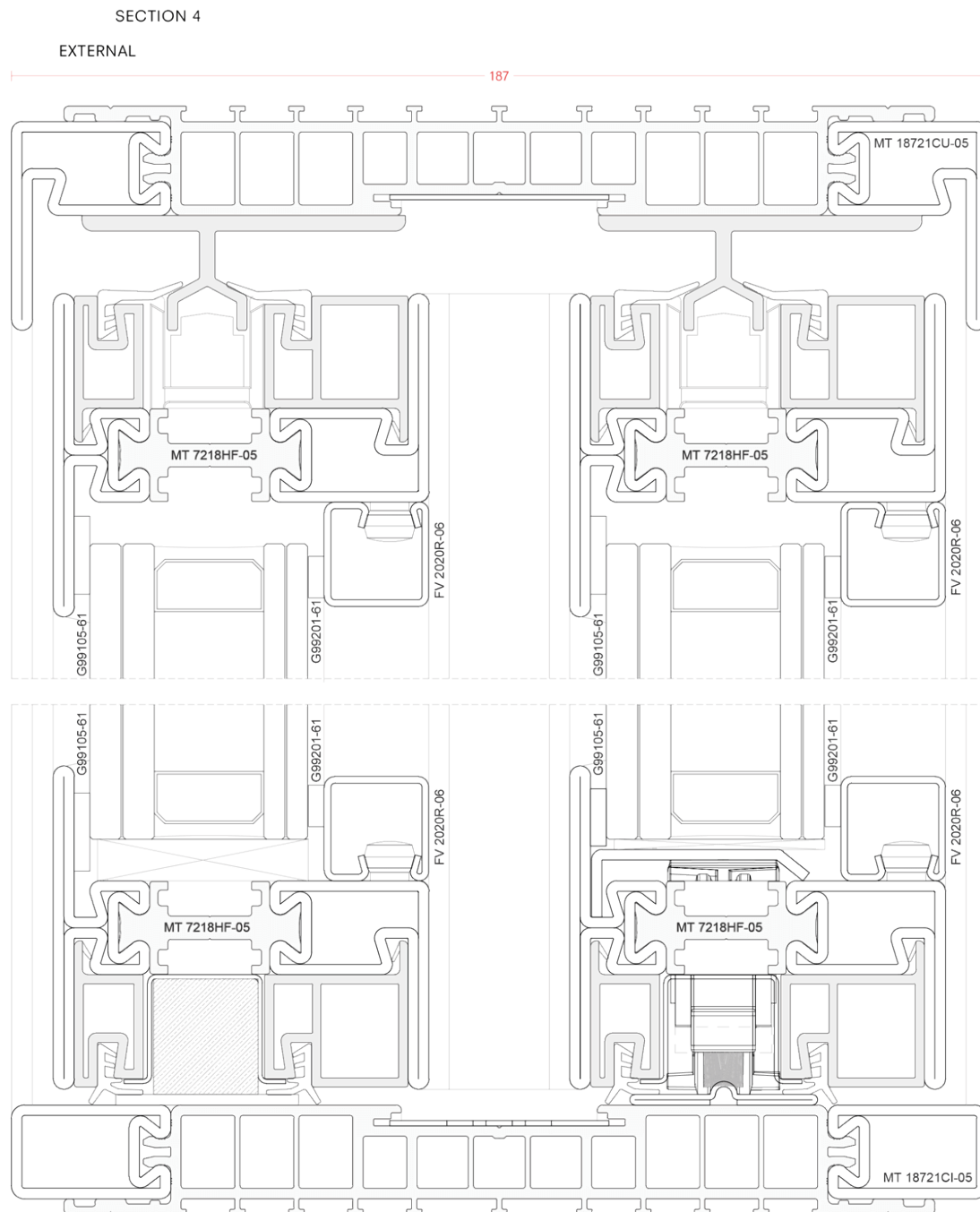

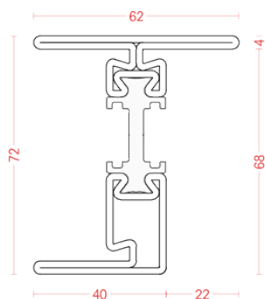

MT 7218HF-02
MT 7218HF-05
MT 7218HF-07

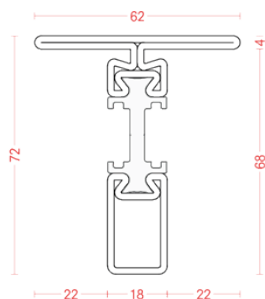

MT 7218TF-02
MT 7218TF-05
MT 7218TF-07

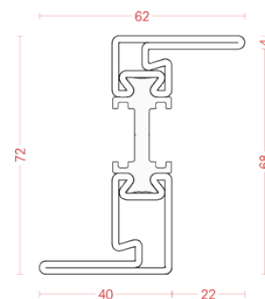

MT 7218ZF-02
MT 7218ZF-05
MT 7218ZF-07

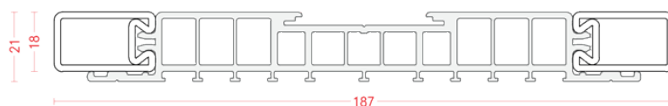

MT 18721CI-05
MT 18721CI-07
L 5800 mm

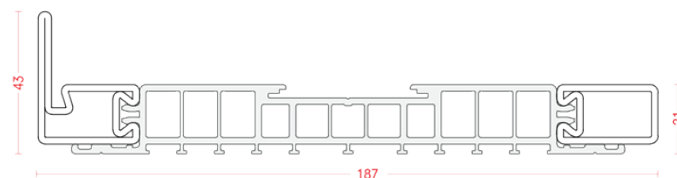

MT 18721CL-02
MT 18721CL-05
MT 18721CL-07
L 5800 mm

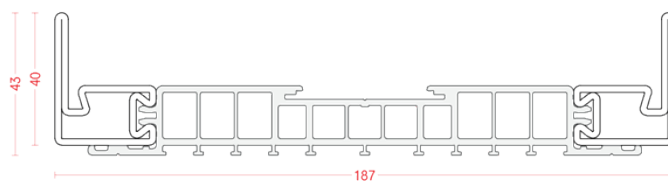

MT 18721CU-02
MT 18721CU-05
MT 18721CU-07
L 5800 mm



E99403-02
E99403-06 L 3000 mm
E99403-07

E99404-02 L 4000 mm
E99404-06



E99405-02
E99405-06 L 3000 mm
E99405-07

E99406-02 L 4000 mm
E99406-06

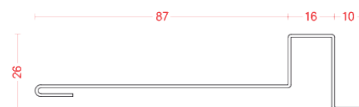

E99408-02
E99408-06 L 3000 mm
E99408-07

E99409-02 L 4000 mm
E99409-06



E99407-06
E99407-07 L 3000 mm



E99401-06 L 4000 mm



E99412-05 L 3000 mm

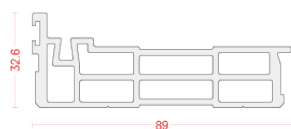

99 8933PL-62 L 4000 mm

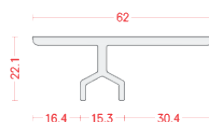

99 6222GU-65 L 5800 mm



99 2813PG-62 L 4000 mm

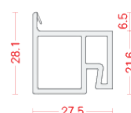

99 2828PG-62 L 4000 mm

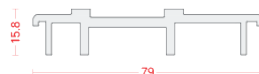

99 7916PL-62 L 5800 mm

snap on glazing beads aluminum - bar lenght 6000 mm

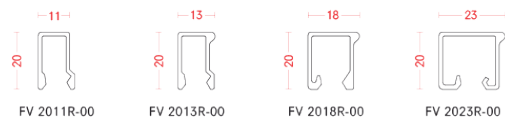

fixing screw



snap on glazing beads steel - bar lenght 6000 mm

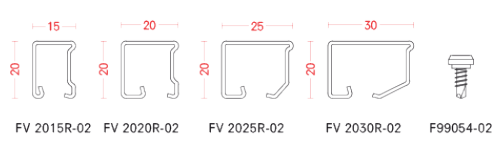

fixing screws

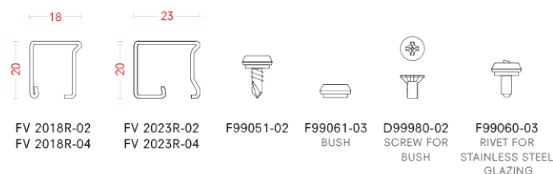

snap on glazing beads satin stainless steel AISI 316L - bar lenght 6000 mm

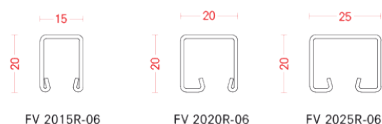

fixing screw



angular screw on glazing beads steel - bar lenght 3000 mm (4000 mm on demand only for material -02 and -06)

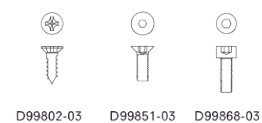
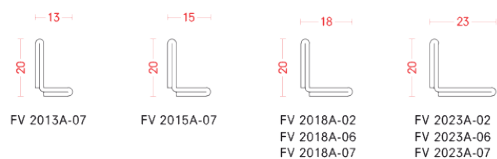

glazing beads satin stainless steel AISI 316L with clip - bar lenght 6000 mm

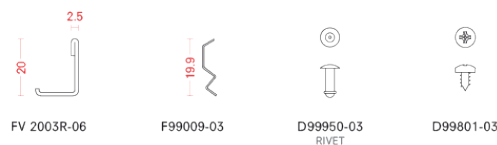

rebate gaskets



glass - external gaskets



METALFORM™

Here to talk

Orion House
Barnhill
Stamford
PE9 2AE

sales@metalform.uk
projects@metalform.uk

+44 (0) 1780 437995

facebook.com/metalformuk
instagram.com/metalform_europe
linkedin.com/company/metalform-group
pin.it/61AyQIm

metalform.uk